

Company Interiors
38433 Holman Internal Graphics

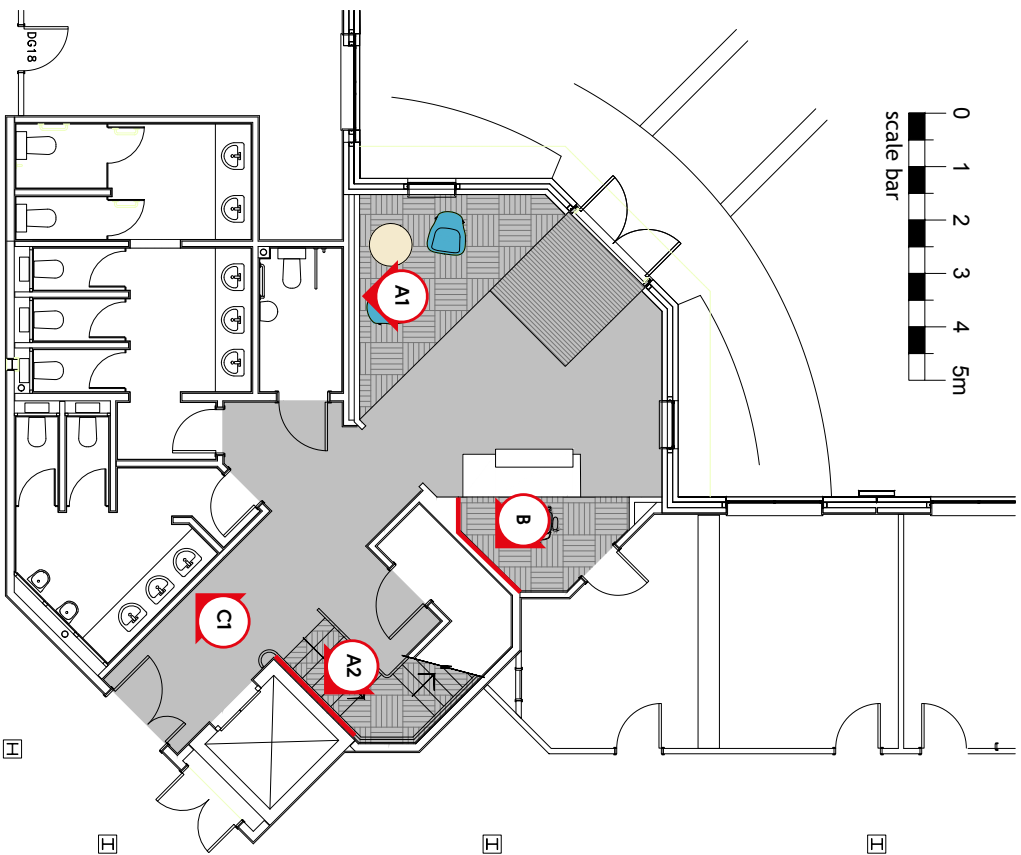
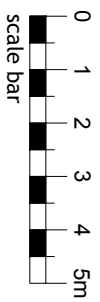

NOTES

All information shown on this drawing is for information only and does not constitute a contract. The client is responsible for providing all necessary information and for ensuring that the information is accurate and complete. The client is responsible for obtaining all necessary permissions and consents from the relevant authorities. The client is responsible for ensuring that the information is up-to-date and accurate. The client is responsible for ensuring that the information is not used for any other purpose without the written consent of the designer. The client is responsible for ensuring that the information is not used for any other purpose without the written consent of the designer. The client is responsible for ensuring that the information is not used for any other purpose without the written consent of the designer.

Company: [Company Name]
 Designer: [Designer Name]
 Date: [Date]
 Scale: [Scale]

CLIENT: Holman ARI

DRAWING TITLE: Reception GA

STATUS: Planning

DRAWN BY: AR

SCALE: 1:50 @A1

DATE: 20.04.22

REV: /

DWG NO: 10595 1|2|GA



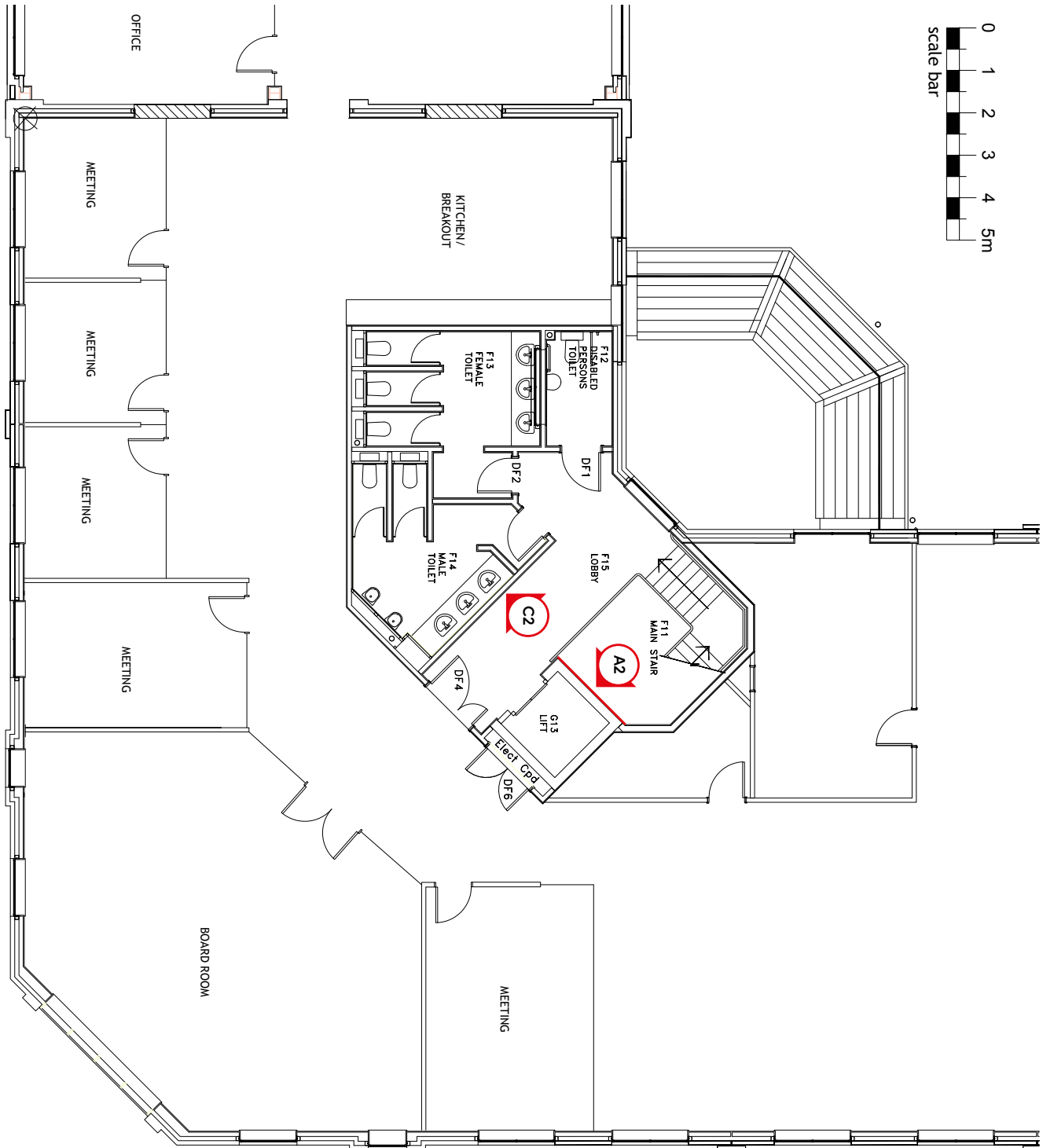
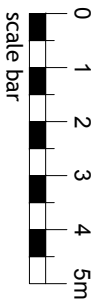

companyinteriors

Registered Office: 50 London, Chippenham, Wiltshire, SN15 2BG
PLEASE DO NOT SCALE OFF OF THIS DRAWING. NO RESPONSIBILITY IS ACCEPTED FOR ERRORS UNTIL THE SITE SURVEY HAS BEEN COMPLETED. UNAUTHORISED USE OR REPRODUCTION IS PROHIBITED WITHOUT WRITTEN CONSENT OF COMPANY INTERIORS. Drawing Copy/Right © www.companyinteriors.co.uk

NOTES
1. This drawing is the property of Company Interiors and is not to be reproduced without written consent.
2. The client is responsible for ensuring that the information provided in this drawing is accurate and complete.
3. The client is responsible for ensuring that the information provided in this drawing is accurate and complete.
4. The client is responsible for ensuring that the information provided in this drawing is accurate and complete.
5. The client is responsible for ensuring that the information provided in this drawing is accurate and complete.

CLIENT: Holman ARI
DRAWING TITLE: First Floor GA
STATUS: Planning
DRAWN BY: AR
SCALE: 1:50 @A1
DATE: 20.04.22
REV: /
DWG No: 10995113 GA

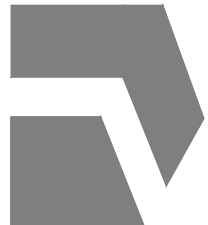

MOSS FITTED AND PRODUCED BY OTHERS

SIGNAGE 1500w x 553h



SATIN WHITE



P 540 C



STARTING THE FEATURE AFTER ALL THE SOCKETS AND FIRE ALARMS

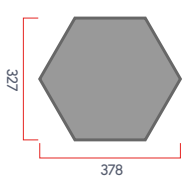
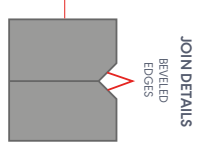
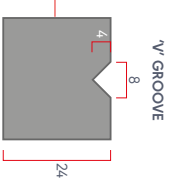
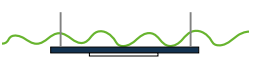
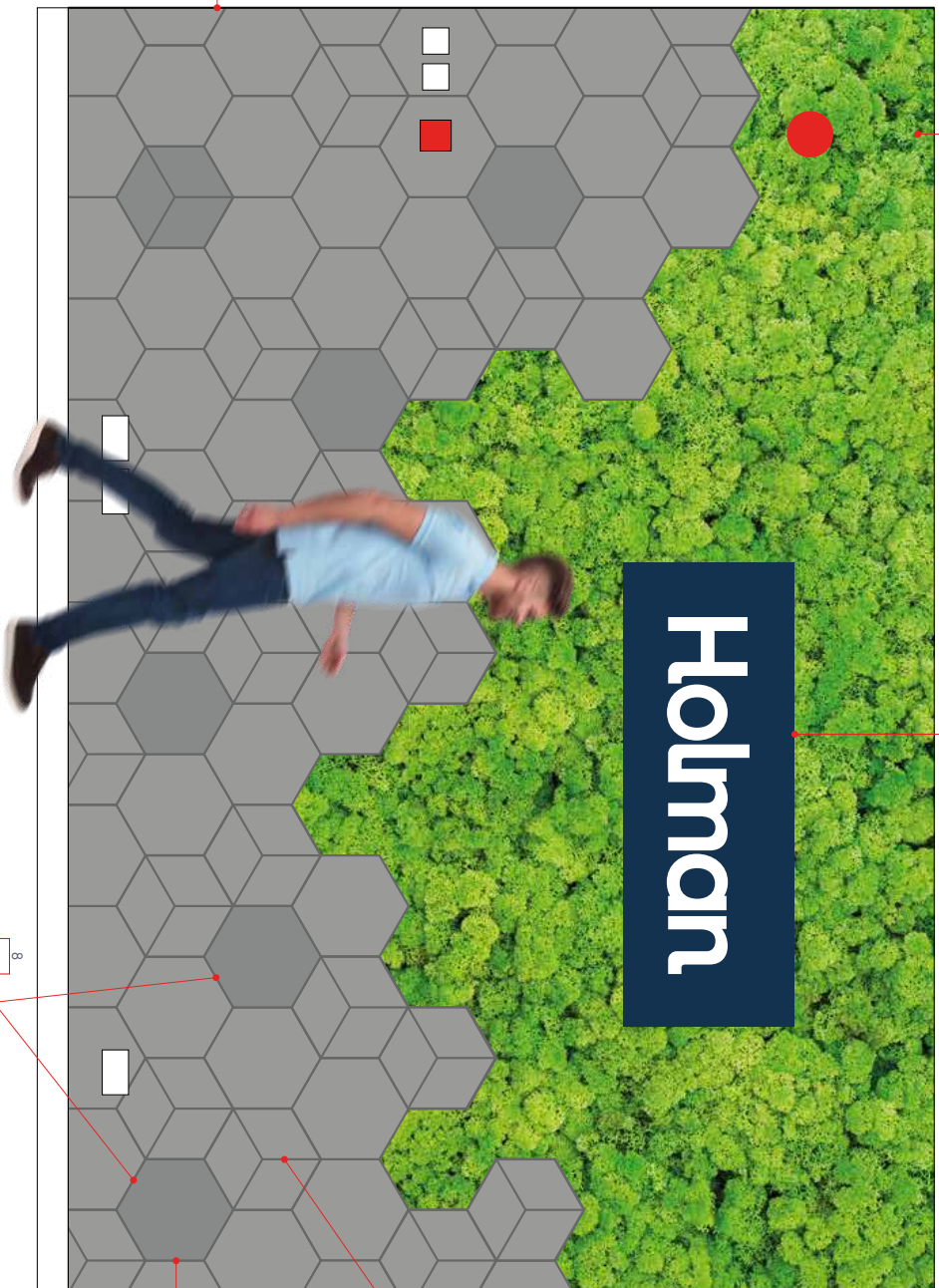

Company Interiors • 38433 Holman Methuen Park Internals, Chippenhams SN14 0UL

Item A: RECEPTION WALL



Artworks Solutions Ltd
Unit 4 Sheeme Road, Bristol BS3 4EG / 42-46 Princelet Street, London E1 5LP
T: 0117 9666 331 e: asclides@artworks-solutions.com w: artworks-solutions.com

Disclaimer: We advise that you review your job carefully before approving. We encourage you to carefully check the content and pay special attention to the following items: spelling, fonts, grammar, punctuation, graphics, colour and finished size. After a proof is approved by yourself, Artworks are not liable for errors and a charge may be applicable to reproduce the artwork.



FONT: Poppins Semi Bold

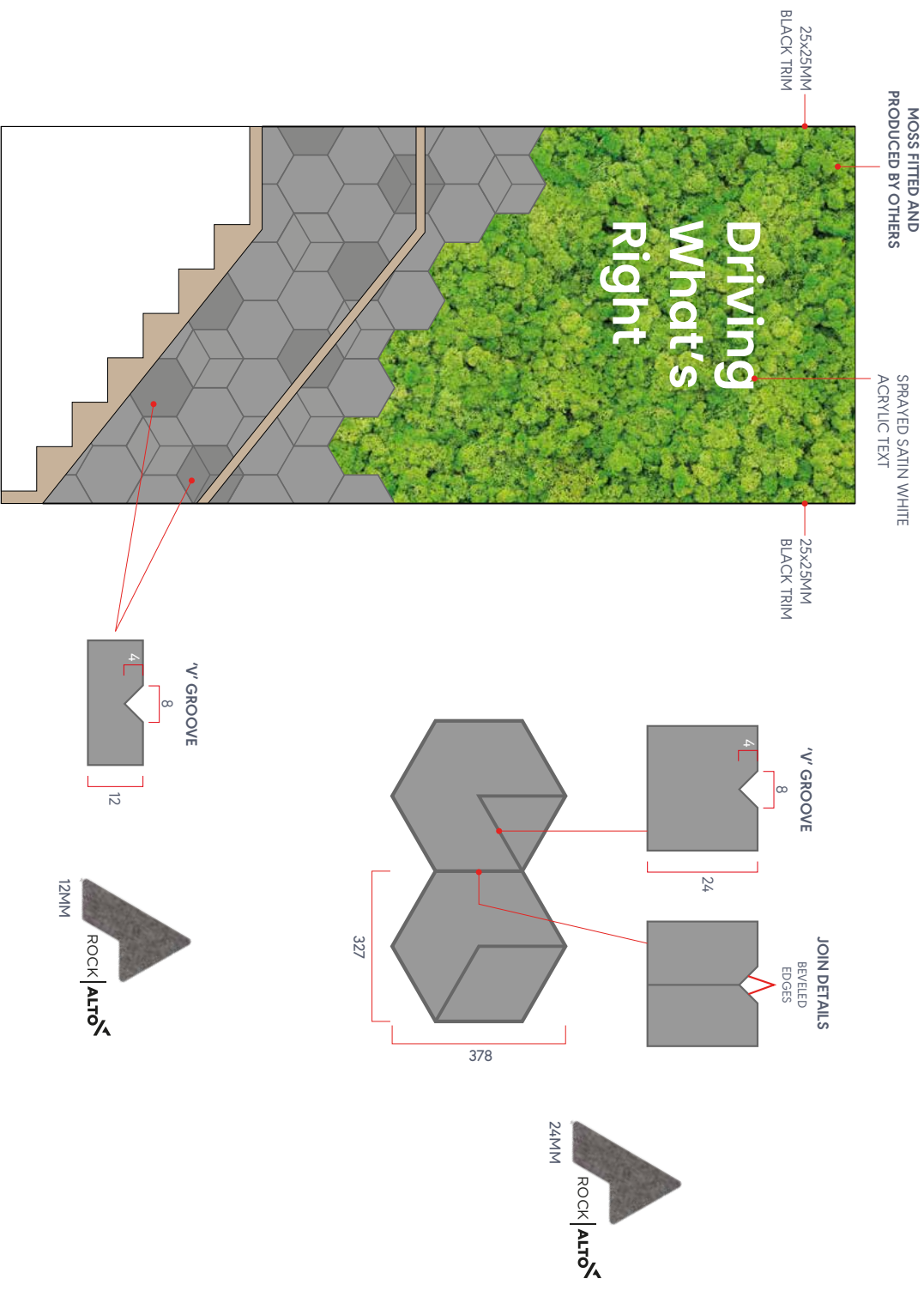

Company Interiors • 38433 Holman Methuen Park Internals, Chippenham SN14 0UL

Item A2: STAIR WALL - ALTO AND SIGNAGE

Artworks Solutions Ltd
Unit 4 Sheeme Road, Bristol BS3 4EG / 42-46 Princelet Street, London E1 5LP
t: 0117 9666 331 e: sales@artworks-solutions.com w: artworks-solutions.com

Disclaimer: We advise that you review your job carefully before approving. We encourage you to carefully check the content and pay special attention to the following items: spelling, fonts, grammar, punctuation, graphics, colour and finished size. After a proof is approved by yourself, Artworks are not liable for errors and a charge may be applicable to reproduce the artwork.



PANTONE
540 C

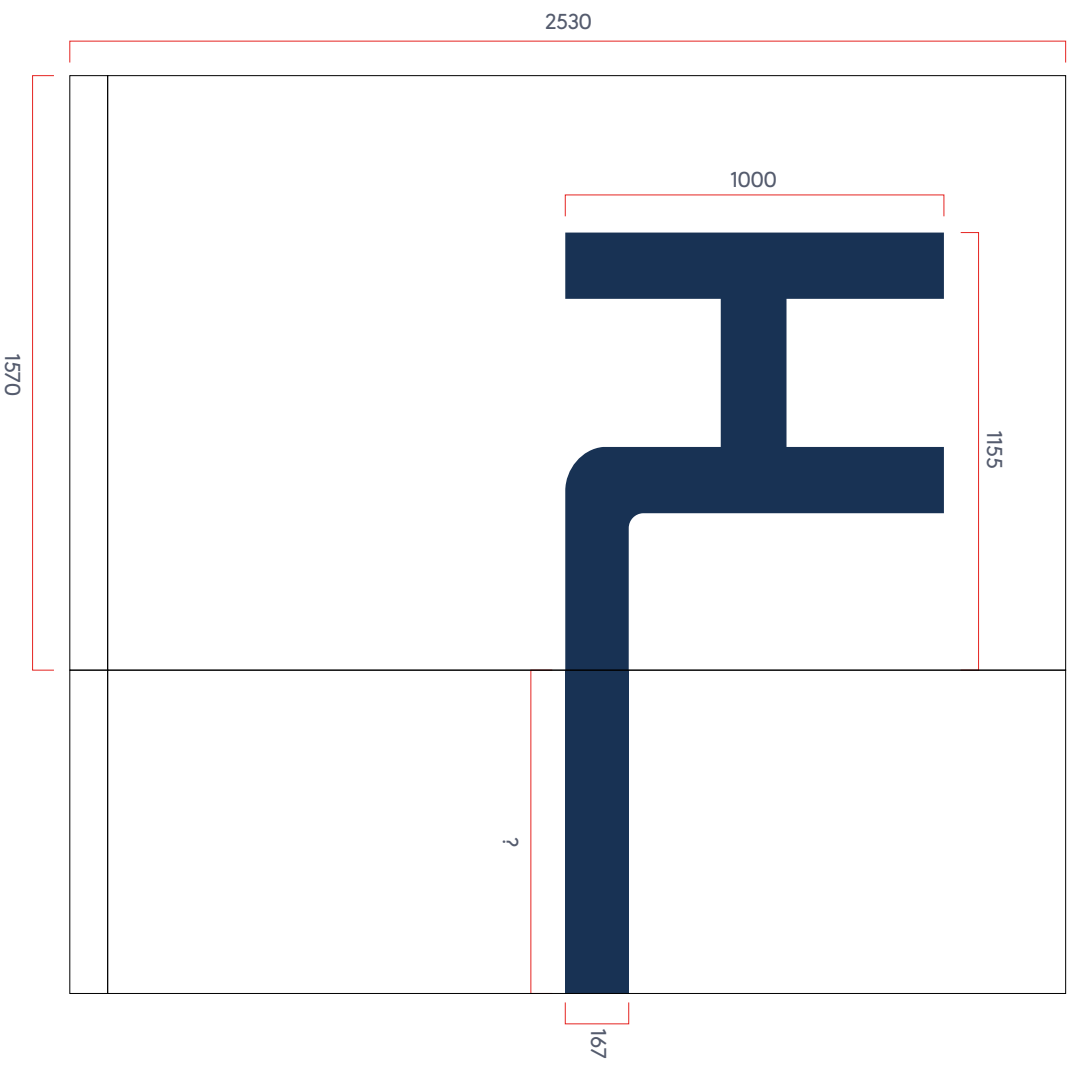

Company Interiors • 38433 Holman Methuen Park Internals, Chippenham SN14 0UL

Item B: RECEPTION SIGNAGE

Artworks Solutions Ltd
Unit 4 Sheeme Road, Bristol BS3 4EG / 42-46 Princeslet Street, London E1 5LP
t: 0117 9666 331 e: sales@artworks-solutions.com w: artworks-solutions.com

Disclaimer: We advise that you review your job carefully before approving. We encourage you to carefully check the content and pay special attention to the following items: spelling, fonts, grammar, punctuation, graphics, colour and finished size. After a proof is approved by yourself, Artworks are not liable for errors and a charge may be applicable to reproduce the artwork.

GROUND - C1

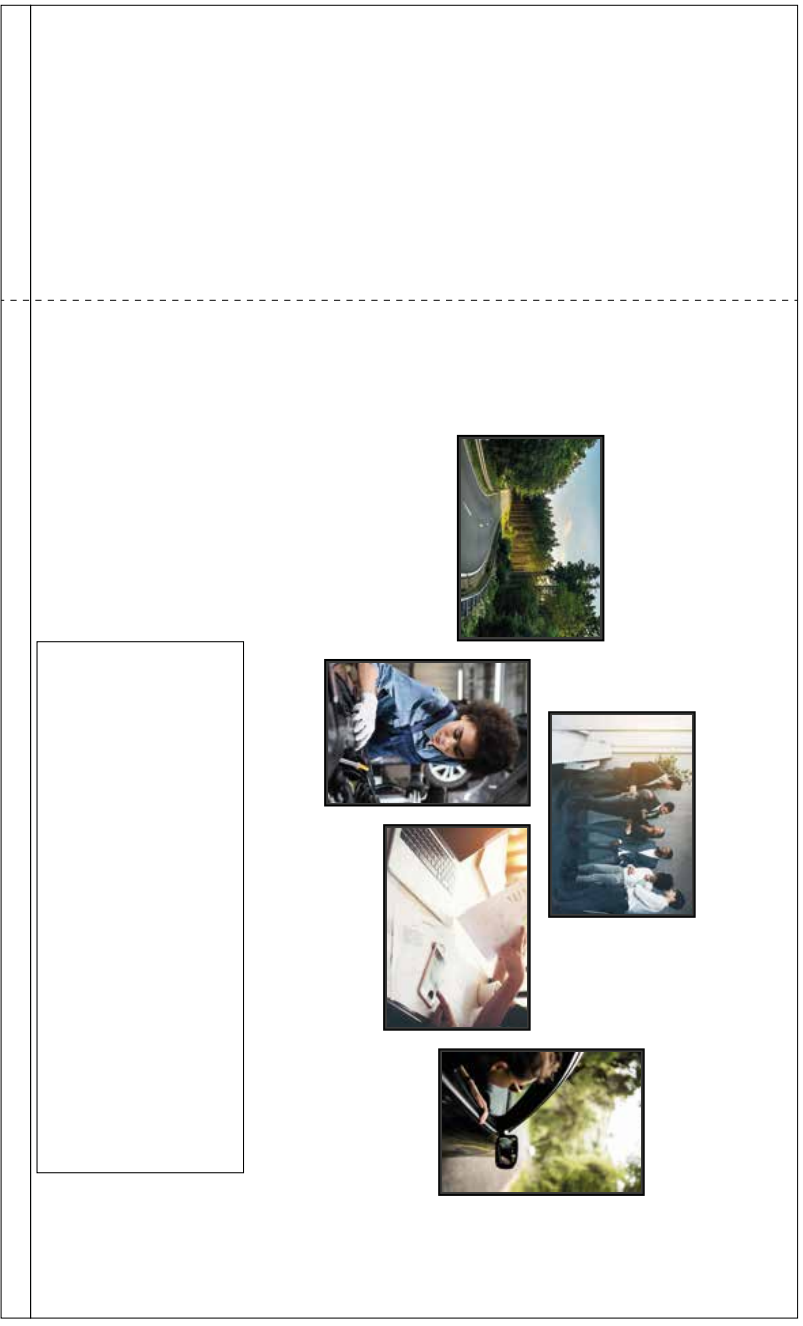
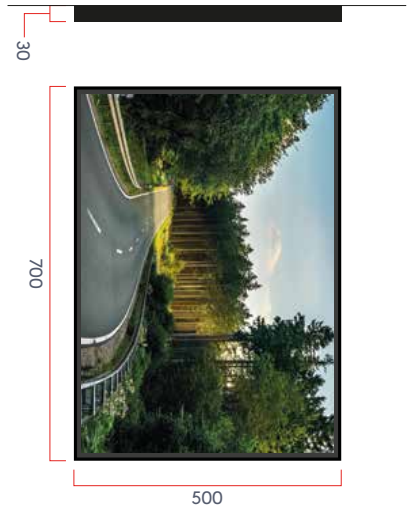
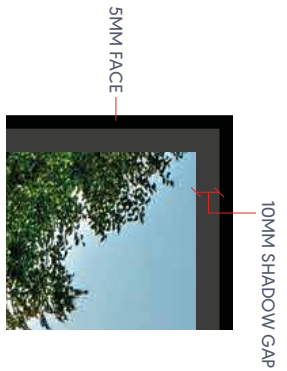

Company Interiors • 38433 Holman Methuen Park Internals, Chippenham SN14 0UL

Item C: FRAMED ARTWORK



FIRST - C2

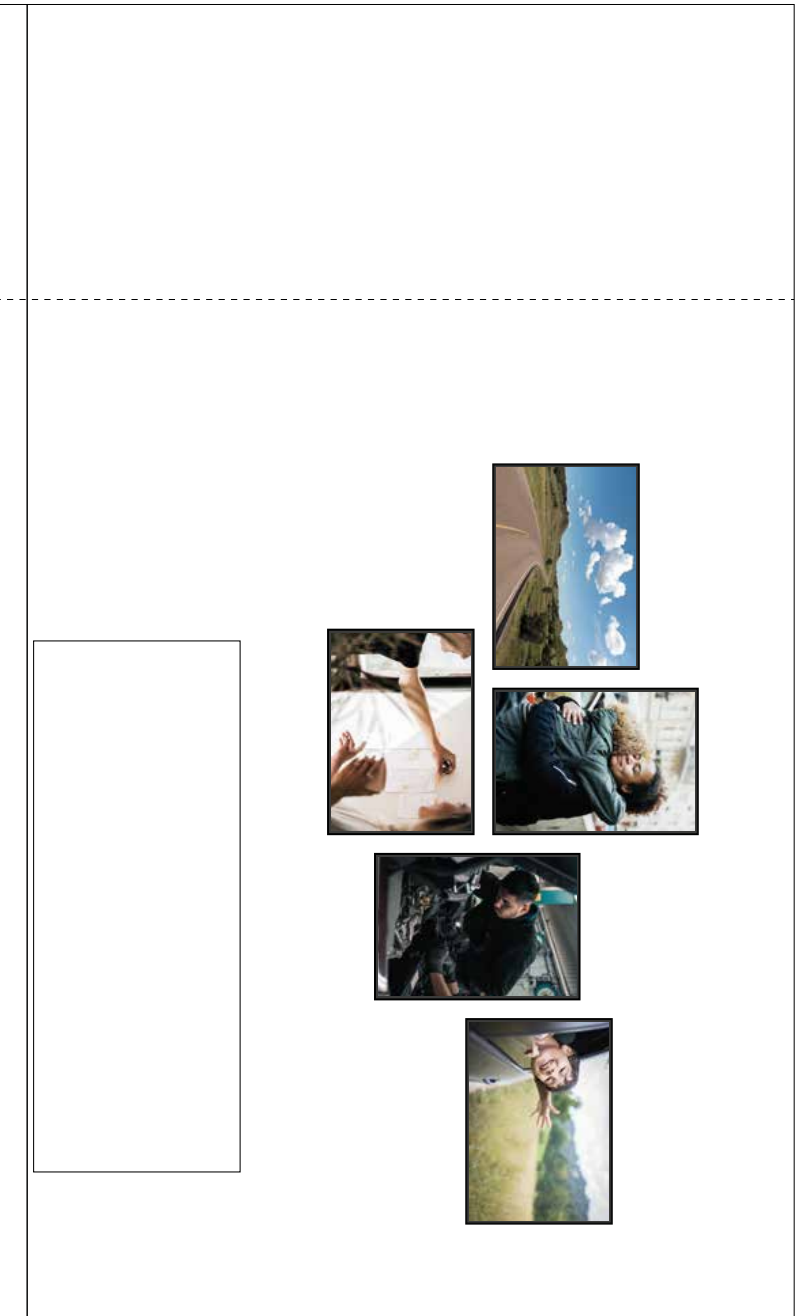
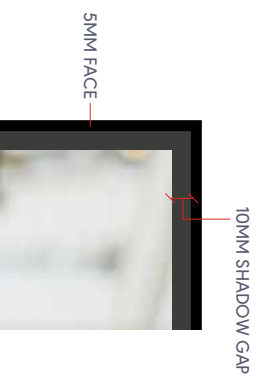

Company Interiors • 38433 Holman Methuen Park Internals, Chippenham SN14 0UL

Item C: FRAMED ARTWORK

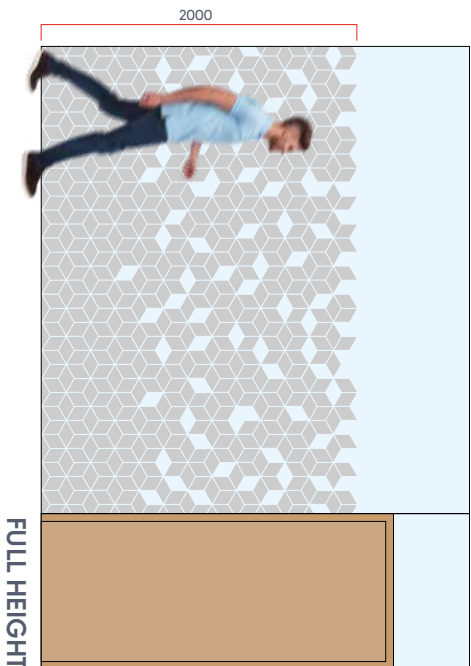

FULL HEIGHT

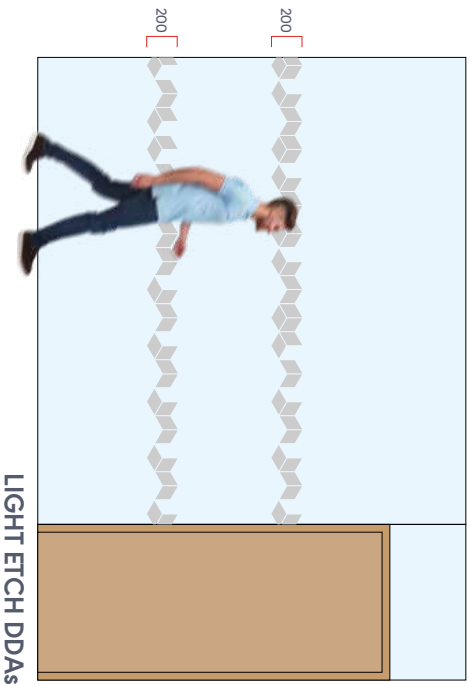

LIGHT ETCH DDAS

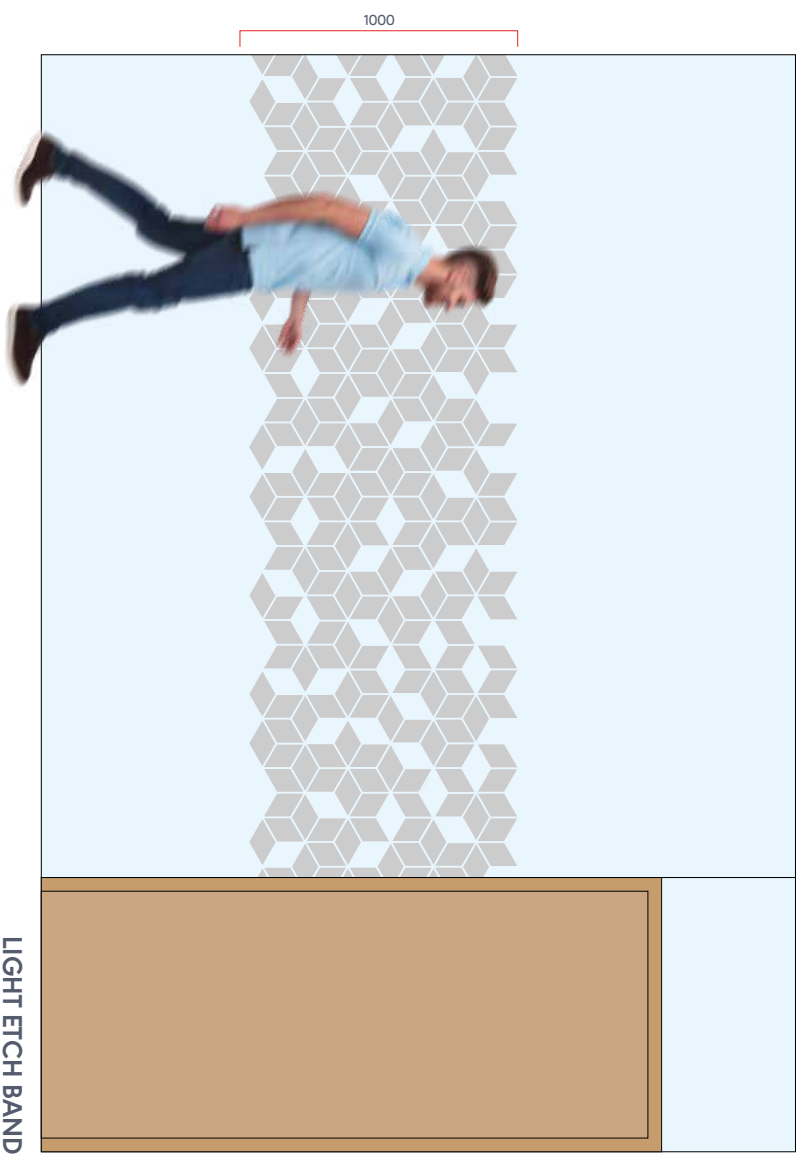

LIGHT ETCH BAND

Company Interiors • 38433 Holman Methuen Park Internals, Chippenham SN14 0UL

Item E: MANIFESTATION

Artworks Solutions Ltd
Unit 4 Sheeme Road, Bristol BS3 4EG / 42-46 Princeslet Street, London E1 5LP
t: 0117 9666 331 e: sales@artworks-solutions.com w: artworks-solutions.com

Disclaimer: We advise that you review your job carefully before approving. We encourage you to carefully check the content and pay special attention to the following items: spelling, fonts, grammar, punctuation, graphics, colour and finished size. After a proof is approved by yourself, Artworks are not liable for errors and a charge may be applicable to reproduce the artwork.

Artworks Solutions Ltd

Unit 4, Sheene Road, Bristol BS3 4EG / 42-46 Princeslet Street, London E1 5LP
t: 0117 9666 331 e: sales@artworks-solutions.com w: artworks-solutions.com

